

# 92 SERIES VERTICAL PLATE CLAMPS

**BEST  
SELLER**

## Standard plate clamps with safety lock

**Working load limit (WLL) 500 - 3000kg**

These clamps are primarily used for transporting sheet metal and steel plates in the vertical position, as well as lifting and rotating through 180°.

They can also be used for transporting steel constructions and profiles. It is recommended to use a pair of plate clamps in conjunction with a spreader beam for long materials which have a tendency to sag or flex.

### Function

The jaw is opened and closed with the locking lever except for the 92-500 which uses a positive spring-loaded cam.

The safety lock spring loads the cam jaw, preventing the clamp from opening even when there is no load on the jaw.

### Workmanship and parts

These plate clamps are service-friendly, making it easy to exchange parts, which are readily available. Clamp repairs are available through the factory, or can be done by a competent person.

**NB: The plate surface of the material must have a hardness level below HRC 30/Brinell 300.**

*\* Spare parts for the  
92 Series plate clamps are  
shown on page 238*



Model	WLL kg*	Jaw (Z) capacity mm	A mm	B mm	C mm	D mm	E mm	F mm	G mm	H mm	I mm	Weight kg**
92-500	50 - 500	0 - 16	99	195	29	33	47	50	48	11	15	1.5
92-1500	100 - 1500	0 - 20	126	225	50	49	70	82	55	13	20	3.0
92-2000	200 - 2000	0 - 32	192	312	80	75	96	100	81	20	24	8
92-3000	300 - 3000	0 - 32	192	320	80	75	96	100	81	30	30	12

**PLEASE NOTE: Units are supplied as standard with a hook ring. Link fitting and chain are available on request as a special order.**

\*Per clamp.

\*\*Weight per clamp with hook ring.

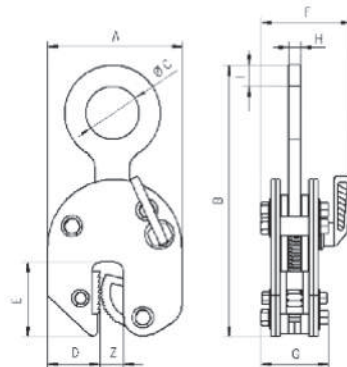

**92 Series plate clamps.**

Working load limit 500 - 3000kg