

**MSA Latchways Personal Rescue  
Device® (Latchways PRD®)**

User Instructions

EN 341:2011  
EN 361:2002  
EN 358:2018  
ANSI Z359.4-2013  
CSA Z259.2.3-16/1/D

**Important document – retain for future use**

EN	English - User instructions	3
FR	Français - Mode d'emploi	16
DE	Deutsch - Bedienungsanleitung	29
NL	Nederlands - Gebruiksaanwijzing	43
DA	Dansk - Brugervejledning	55
NO	Norsk - Bruksanvisning	67
SV	Svenska - Användarinstruktioner	80
ES	Español - Instrucciones de usuario	93
IT	Italiano - Istruzioni per l'uso	106
PT	Português - Instruções para o usuário	119
FI	Suomi - käyttöohjeet	132
RO	Română - Instrucțiuni de utilizare	144
PL	Polski - Instrukcje użytkownika	157
CS	Čeština - Návod k použití	170
HU	Magyar - Felhasználói utasítások	182
BG	Български - Инструкции за употреба	195
SK	Slovenčina - Návod na použitie	207

EN	<b>Date of first use</b>		dd / mm / yy
----	--------------------------	---	--------------

- |    |  |    |                                    |
|----|--|----|------------------------------------|
| FR | <b>Date de première utilisation</b>                          | PT | <b>Data da primeira utilização</b> |
| DE | <b>Datum der ersten Nutzung</b>                              | FI | <b>Ensimmäinen käyttöpvm</b>       |
| NL | <b>Datum waarop het product voor het eerst werd gebruikt</b> | RO | <b>Data primei utilizări</b>       |
| DA | <b>Dato for første ibrugtagning</b>                          | PL | <b>Data pierwszego użycia</b>      |
| NO | <b>Dato for første gangs bruk</b>                            | CS | <b>Datum prvního použití</b>       |
| SV | <b>Datum för första användning</b>                           | HU | <b>Első használat dátuma</b>       |
| ES | <b>Fecha de primer uso</b>                                   | BG | <b>Дата на първа употреба</b>      |
| IT | <b>Data di primo utilizzo</b>                                | SK | <b>Dátum prvého použitia</b>       |

# MSA Latchways PRD certificate of conformity

① MSA serial number \_\_\_\_\_ ② Date of manufacture: dd / mm / yy

① Harness serial number: \_\_\_\_\_ ② Date of manufacture: dd / mm / yy

③ We certify that this item has been fully inspected and conforms to the full requirements and specifications of the standards indicated on the product. (tick applicable box):

ANSI Z359.4-2013     CSA Z259.2.3-16/1/D     EN 341: 2011     EN 358: 2018  
 EN 361: 2002.

We certify that this item has been fully inspected and conforms to the full requirements and specifications of the standards indicated on the product. This product meets the requirements of the PPE regulation 2016/425 and PPE Regulation (EU) 2016/425 as retained in UK Law and amended using harmonised/ designated standard EN 360: 2002.

The quality control arrangements adopted in respect of this item conforms to the conditions of EN ISO 9001:2015.

Issue date: dd / mm / yy    Place: Devizes, UK

④ Signed/(inspection stamp): \_\_\_\_\_

Manufactured by	Attestation of conformity	Production control phase
Latchways plc Hopton Park Devizes Wiltshire SN10 2JP United Kingdom Tel: +44 (0)800 066 2222 email: info.gb@MSAsafety.com <b>MSAsafety.com</b>	Notified Body number 2777 SATRA Technology Europe Ltd Bracetown Business Park Clonee D15 YN2P Ireland Tel: 00353(0)14372484	Notified Body number 2849 INSPEC International B.V. Beechavenue 54 1119 PW Schiphol-Rijk Netherlands Tel: (0161) 73 70 699

UKCA Approval	Approved body for product certification:	Approved Body for site surveillance:
	SATRA Technology Centre Limited, Wyndham Way, Telford Way, Kettering, Northamptonshire, NN16 8SD, United Kingdom (AB0321)	INSPEC International Ltd, 56 Leslie Hough Way, Salford, Greater Manchester, M6 6AJ, United Kingdom (AB0194)

# Latchways PRD certificate of conformity

## Disclaimer

Every effort has been made to ensure that the information contained within these user instructions is both accurate and current. As part of MSA's continuous improvement programme changes may be made to the product after the publication date. Therefore, occasionally, the product and these instructions may slightly differ.

A declaration of conformity may be downloaded at [MSAsafety.com/DoC](http://MSAsafety.com/DoC)

## Warranty details

MSA warrants the Latchways PRD, excluding auxiliary components, against defects in materials and workmanship for one year from the date of the original purchase by the consumer. MSA does not warrant against normal wear and tear, nor damage caused by accident or abuse. If a claim is submitted under warranty, MSA will either repair, replace or refund the Latchways PRD at MSA discretion. Warranty benefits are in addition to any statutory rights provided under local consumer legislation. Full terms and conditions can be found at [MSAsafety.com/warranty](http://MSAsafety.com/warranty).

**Date of first use\***: (page 2) The date the unit is removed from the packaging.

## Periodic examination log (page 224)

To be completed by a Competent person at least every 12 months from the date of first use\* and retained. Periodic examinations are an important element for maintaining product safety and shall be completed in accordance with MSA instructions. Latchways PRD's scheduled for examination shall be withdrawn from service.

**A** See completed example below for guidance.

1	2	3	4	5
Date	Inspected by (block capitals)	Signature	Examination completed/ comments	Date of next examination
21 / 10 / 15	D. HEARSON	<i>D. Hearson</i>	✓ <input checked="" type="checkbox"/> PASSED	21 / 10 m / 16

\*Date of first use shall be administratively provable. Where the date of first use is unknown, then the next previous administratively provable date shall be used, e.g. date of purchase or date of manufacture.

## Latchways PRD label product markings

- B Descent device label (see page 220/221)
- C Backpack label (see page 221)
- D Harness label (see page 221)

1 Model	9 Serial number	16 Do not use
2 Manufacturer	10 Notified body	17 Latest disposal date
3 Applicable standards	11 Next examination date	18 Harness materials
4 Read the manual	12 Date of manufacture	19 Examine at least annually
5 Max descent height	13 Part number	20 No modifications or repairs
6 User weight	14 Designated attachment point (Figure 17)	21 For single user
7 Operating temperature	15 Size	22 For single descent
8 Operating instructions		

### 8 Operating instructions:

1. Check before each use and follow the manufacturer's instructions.
2. Avoid descending into electrical, thermal or chemical sources or other hazards.
3. Check the ground below is clear of obstructions and sharp edges and a safe landing is possible.
4. Open flap on right shoulder.
5. Pull cord sharply.
6. Bend knees and prepare for landing.

## Latchways PRD user instructions

**The User shall read and understand the user instructions before use and shall follow the user instructions when using the equipment. These instructions and corresponding inspection records shall be retained for future reference and should be used as part of an employee training programme.**

**It is essential for the safety of the user that if the Latchways PRD is resold outside the original country of destination, the reseller shall provide instructions for use, maintenance, periodic examination and repair in the language of the country in which the device will be used.**

**Before use it shall be ensured that the serial number of the harness and the descent device match those listed on the certificate of conformity and equipment record sheet.**

## Intended purpose

The Latchways PRD comprises a full body harness with integral descender device which can be used for one descent only. The Latchways PRD is intended to be used as part of a fall arrest system and, in the event of a fall, the descent device can be activated by the User or rescuer to lower the User safely to a lower level. Once activated, the descent speed is automatically limited and requires no further input from the User. The Latchways PRD should be a personal issue item.

<b>Descender model number</b>	<b>R20 (68200-00)</b>
Maximum descent height	20 m / 65 ft
Descent energy	34,300 J / 25,300 ft/lbF
Descent line type	5.4 mm (3/16 in) diameter Ultra-High Molecular Weight Polyethylene (UHMWPE) core, Aramid overbraid rope

<b>Harness model number</b>	<b>Description</b>	<b>Materials</b>
RH2-Part no: 68002-00	Two point, fall arrest harness with quick release buckles, adjustable length shoulder straps; adjustable length leg straps.	Polyester webbing with powder coated aluminium fittings and steel chest attachment point.
RH3-Part no: 68003-00	Four point, fall arrest harness with quick release buckles; adjustable length shoulder straps; adjustable length leg straps; adjustable length waist belt with work positioning attachments.	Polyester webbing with powder coated aluminium fittings, steel chest attachment point and steel side attachment point.

## Personal requirements

The Latchways PRD shall only be used by a person who is trained and competent in its safe use. Fitness and age significantly affect a person's ability to safely withstand fall arrest loads. Only people who are physically and mentally fit and healthy, not under the influence of drugs or alcohol are permitted to use this equipment. Medical advice should be sought if a User's suitability is unclear. The Latchways PRD shall not be used by pregnant women or minors.

## Product limitations

The Latchways PRD shall only be used within its limitations and the purpose for which it is intended. All examinations shall be conducted by a Competent person. No attempt shall be made to modify or repair the equipment. All instructions shall be followed to ensure the safety of the User. Harnesses shall be changed by Technicians in accordance with MSA instructions.

- Total user weight (including tools) 59 kg min – 140 kg max (130 lbs min 310 lbs max).
- The Latchways PRD is for a single user, for rescue purposes only.
- Use of this equipment in hazardous environments may require additional precautions to reduce the possibility of injury to the user or damage to the equipment. Hazards may include, but are not limited to: high heat, fires, acids, caustic solutions, welding flames, explosive or toxic gases, corrosive environments, sharp edges, moving machinery.
- Standard operating temperature -20°C to +60°C (-4°F to +140°F).
- Extended operating temperature -40°C to + 60°C (-40°F to +140°F). If the unit is used between -40°C to -20°C (-40°F to -4°F), it must be in a dry condition before use.
- Descent speed is between 0.5 – 2 m/sec or 1.6 – 6.6 ft/sec.
- After a single descent, the descender device shall be withdrawn from service, details recorded on the periodic examination log and returned to MSA or an authorised agent.
- Should a fall occur and the fall arrest harness be subjected to fall arrest loads, it shall be withdrawn from service.
- The life of the product can be affected by environmental conditions.

## Pre-use checks and requirements

### Risk assessment and rescue planning

The Latchways PRD forms part of a fall protection system and it is therefore recommended that before undertaking work at height and at regular intervals during the period of work, a risk assessment is carried out. The risk assessment should cover, but is not limited to, **descent height, descent path, suitability of landing areas, unprotected edges and rescue.**

A rescue plan shall be in place to deal with any emergency that may arise.

The Latchways PRD is designed, primarily, as a self-rescue system and will assist with rescue planning. In the event that the User is unable to initiate self-rescue a secondary release means is provided on the right-hand shoulder area. This is a red and black rubberised loop (figure 3a) which can be pulled by a rescuer, by hand or with the aid of the Latchways PRD Rescue Pole (figure 3b) or by other means, to activate the descent. A telescopic pole assembly is available (MSA part number 68099-00) for this purpose. Secondary release by a rescuer should be taken into account in the risk assessment.

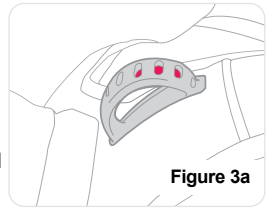

Figure 3a

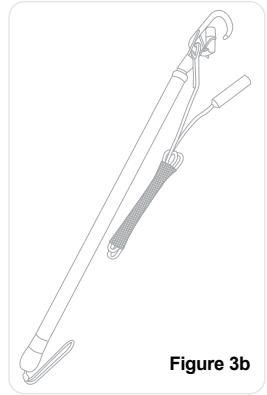

Figure 3b

### Anchor point requirements

<b>EN</b>	The anchor point shall be able to sustain a minimum load of 12 kN (2700 lbs). Refer to EN 795:2012 or CEN/TS 16415:2013.
<b>ANSI</b>	The anchor point shall be able to sustain a minimum certified load of 3600 lbs (16 kN) or 5000 lbs (22.2 kN) in the absence of certification. Refer to ANSI Z359.14-2012 CLASS B.
<b>CSA</b>	The anchor point shall be able to sustain a minimum load of 5000 lbs (22.2 kN). Refer to CSA Z259.15 CSA Z259.13, CSA Z259.15

Note: If multiple fall arrest systems are attached to the same anchor point the strength requirement shall be multiplied by the number of personal fall arrest systems.

### Lanyard

Always use an energy absorbing lanyard or retractable type fall arrestor that complies with the relevant standards within the country of use. In some harness variants, side attachment points are included. These attachments are only to be used for a suitable work positioning lanyard.

<b>EN</b>	EN 358
<b>ANSI</b>	ANSI Z359.1 or ANSI Z359.13
<b>CSA</b>	CSA Z259.2.2, CSA Z259.11





## Connectors

Connectors shall conform to the relevant national standards and must be compatible.

<b>EN</b>	EN 362:2004
<b>ANSI</b>	ANSI Z359.1 or Z359.12
<b>CSA</b>	CSA Z259.12

## Pre-use checks

The Latchways PRD has been designed to be easy to use, incorporating a range of features to aid pre-use checks and on-site periodic examination. This minimises the need to return the device to MSA or an authorised agent. No repairs, modifications or alterations are to be carried out on the Latchways PRD. If any part of the Latchways PRD is found to be faulty, or a fault is suspected, the device shall be removed from service and advice sought from MSA or an authorised agent.

	
Problem identified	Passes checks

## Descent device/line

The following checks shall be carried out each time the Latchways PRD is used:



Figure 4

- Inspect the attachment point connector for signs of damage, excessive wear, distortion, corrosion or cracking.
- Ensure that the descent line is not paid out of the device, this would indicate that a descent has occurred (Figure 4). If descent line is paid out the Latchways PRD shall be removed from service and advice sought from MSA or authorised agent.
- *Note: Attachment point size and shape may differ from that shown in the diagram.*

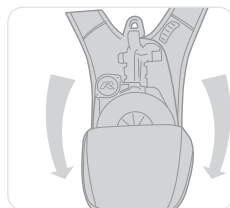

Figure 5

- Open the backpack containing the descent device (Figure 5).
- Inspect the general condition of the descent device for signs of damage or corrosion. If damaged the Latchways PRD shall be removed from service and advice sought from MSA or authorised agent.

## Pre-use checks

### Descent device/line (continued)

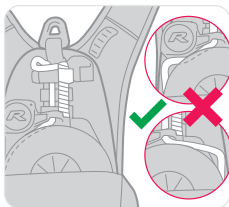

Figure 6

- Inspect descent line for any 'slack' between the drum and rack (Figure 6). If the line is slack the Latchways PRD shall be removed from service and advice sought from MSA or authorised agent.

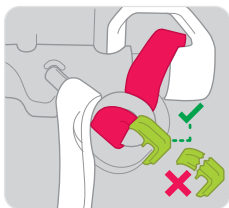

Figure 7

- Check the legibility of the product markings.
- Inspect the release pin for signs of damage, distortion, corrosion or cracking. Ensure that it is engaged. Ensure that the red release cord is positioned under the release pin and that the load-line webbing is looped around the release pin (Figure 7).
- Ensure that the green release pin clip is present and undamaged—check for signs of damage, distortion or cracking (Figure 7).

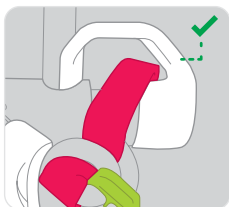

Figure 8

- Ensure that the release cord guide is undamaged (Figure 8).
- Inspect the descent line, load-line and release cord for signs of cuts, abrasion, fraying, tears, mould, discolouration, chemical attack or excessive build-up of dirt. Check the stitching for signs of loosening, pulling or cut thread. Excessive build-up of dirt may prevent the descent line from pulling through the device. If damage is apparent the Latchways PRD shall be removed from service and advice sought from MSA or authorised agent.
- After inspection close the zip on the backpack fully.

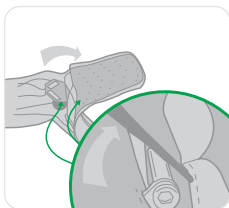

Figure 9

- Unzip the back panel of the backpack and inspect the harness connector for signs of damage, distortion, corrosion or cracking. Ensure that the fastening bolt is secure (Figure 9). If damage is apparent or the bolt insecure the Latchways PRD shall be removed from service and advice sought from MSA or authorised agent.
- Inspect all system components and subsystems according to MSA' instructions.

## Harness

- A harness is designed to arrest a single fall from height only once. If subjected to an arrested fall the harness shall be withdrawn from service and destroyed.
- Check the legibility of the product markings on the harness.
- Check all webbing for signs of cuts, abrasion, fraying, tears, burns, mould, discolouration or chemical attack. Ensure the harness is free from paint overspray.
- Check all stitching for signs of loosening, pulling or cut thread. There must be no evidence of damaged stitching on either side of the stitch pattern.
- The Latchways PRD shall only be used with MSA' approved harnesses. Do not replace or attempt to replace the harness without appropriate training.
- Ensure the harness is within its service life.

## Using the Latchways PRD

### Fitting and adjusting the harness

The safety of the User is dependent upon a correctly fitted harness. This shall be worn over any clothing.

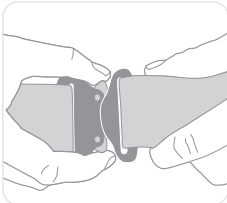

Figure 10

- Complete a pre-use check (page 9).
- Ensure that no items are positioned between the webbing and the Users body. Pay particular attention to pockets and hanging clips, such as key clips.
- Undo the quick release buckles fitted to the chest and leg straps (Figure 10).

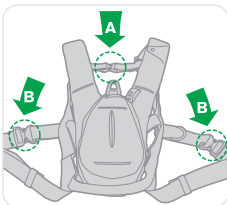

Figure 11

- Put arms through the shoulder straps and connect chest buckle (A) (Figure 11).

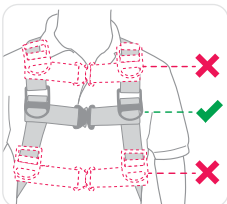

Figure 12

- The chest strap shall be squarely in line with the sternum (breast bone) (Figure 12).
- The connection point on the descent device shall be positioned squarely between the shoulder blades.

## Using the Latchways PRD

### Fitting and adjusting the harness (continued)

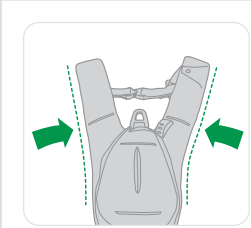

Figure 13

Note: If adjustment of the shoulder straps is required, remove the harness and undo the zips on either side of the backpack (Figure 13). Adjust the shoulder straps by sliding the shoulder strap adjustment buckles and cross strap buckle (where the shoulder straps cross). Check adjustment by continuing to try on the harness until the chest strap and connection point are correctly positioned.

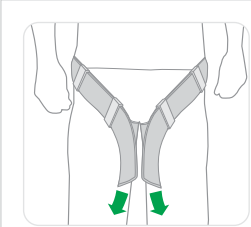

Figure 14

- Connect the leg buckles (B) (Figure 11). Adjust the leg strap by pulling the straps through the buckles to achieve a snug fit (Figure 14).

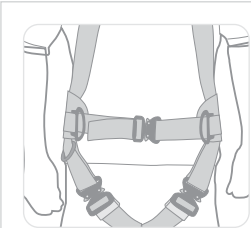

Figure 15

- Where included (RH3 harness only), connect the waist belt buckle at the front, and adjust the strap by pulling the strap through the buckle to achieve a snug fit (Figure 15).

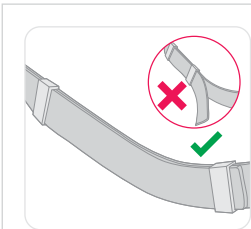

Figure 16

- Use the plastic sliders to secure any free strap. (Figure 16).

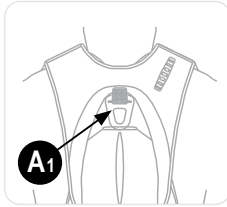

Figure 17

- Connect the karabiner of the energy absorbing lanyard to the fall arrest attachment point marked **A1** (Figure 17). **A1** is the only attachment point that will operate the Latchways PRD rescue function.

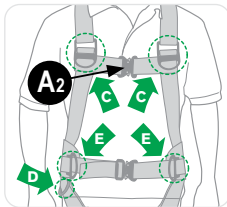

Figure 18

- C: Plastic breakaway lanyard stowage points. Not a fall arrest attachment point.

D: Stainless steel toolbag attachment point. Not a fall arrest attachment point.

**A2**: Front (chest) attachment. For climbing/fall arrest only

E: Side attachments (where included). For work positioning only —not a fall arrest attachment point.

(Figure 18).

When the harness is worn for extended periods of time, straps and adjustment buckles shall be regularly checked to ensure a snug fit is maintained.

### Additional fall arrest attachments

Additional fall arrest attachment points are provided on some harness variants. These may be used as attachments for energy absorbing lanyard/ladder climbing equipment and work. The Latchways PRD rescue facility will operate on the rear attachment point **A1** only.

### Work positioning attachments

Some harness variant include side attachment points. These attachments shall only be used with a suitable work positioning lanyard, adjusted to restrict the wearer's movement to a maximum of 0.6 m. The intention of this is to allow the user to secure themselves in position to free up hands for work. Where work positioning is used, this shall always be backed up with a fall arrest system (e.g. energy absorbing lanyard) attached to the front or rear attachment. A work positioning lanyard should never be the sole method of protecting the User.

## Using the Latchways PRD

### Activating self-rescue

Figure 19

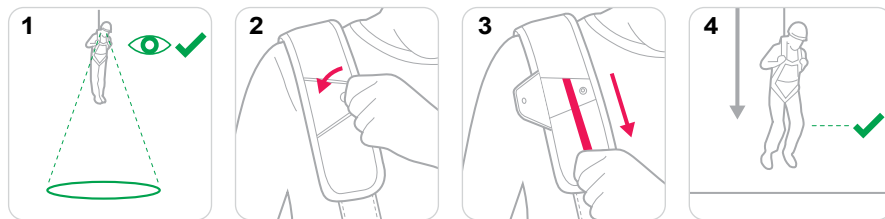

**1** Check the ground below to ensure descent path is clear and a safe landing is possible.

**2** Open the flap on the right shoulder strap to access the release cord.

**3** Pull sharply on the release cord.

**4** Prepare for landing by bending knees.

During a descent it may be possible to land on a lower part of a structure, this is not recommended as it may cause slack in the system and provided potential for a secondary fall.

- Following a descent, internal components of the Latchways PRD may become hot. Allow to cool before opening the backpack.
- After a descent, the Latchways PRD must be withdrawn from service and details recorded on the periodic examination log.

### Periodic examination

The Latchways PRD is a key component in an emergency rescue plan. To assess functionality periodic examinations shall be completed at least every 12 months, from the date of first use, in accordance with MSA instructions. Local requirements, environmental conditions or frequency of use can dictate more frequent examination. The periodic examination shall be recorded in the periodic examination log.

Periodic examination instructions may be downloaded from [MSAsafety.com](http://MSAsafety.com).

The service life of the Latchways PRD, based upon its textile elements, has been evaluated to be up to 10 years. Factors such as (but not limited to): environmental conditions (eg contact with chemicals, exposure to temperatures  $>60^{\circ}\text{C}$  ( $>140^{\circ}\text{F}$ )), incorrect storage and frequency of use may reduce the service life.