



# LOAD-MASTER

Load Monitoring • Force Measurement • Industrial Weighing

## LOAD-MASTER LITE Tension Load Cell

- Rated capacities from 1000kg to 4750kg
- Cabled (LML-C) and Wireless (LML-W) versions
- Lightweight high strength aluminium alloy load cell

LOAD-MASTER LITE tension link load cells provide the ideal solution for **proof load testing** structures and rigging, **load measurement** of hoists and lifting equipment, and as crane scales for **weighing** suspended loads. Ultra compact size and lightweight yet retaining the high safety factors required for lifting and material handling. LOAD-MASTER LITE load cells guarantee safe and accurate measurements in all industrial processes. LML-C and LML-W standard portable systems include handset display with 'tare' and 'peak hold' function. Also available with a range of single and multi-channel indicating, recording & control instruments.

Capacity	Divisions	A	B	C	D	ØE	Shackle Size *
1000	0.5	140	63	18.5	95	17	2
2000	1	140	63	18.5	95	17	2
3250	1	148	63	24	95	20	3.25
4750	1	148	63	27	95	24	4.75
kg		mm					tonne

\* Suggested suitable shackle: Van Beest Green Pin G-4163

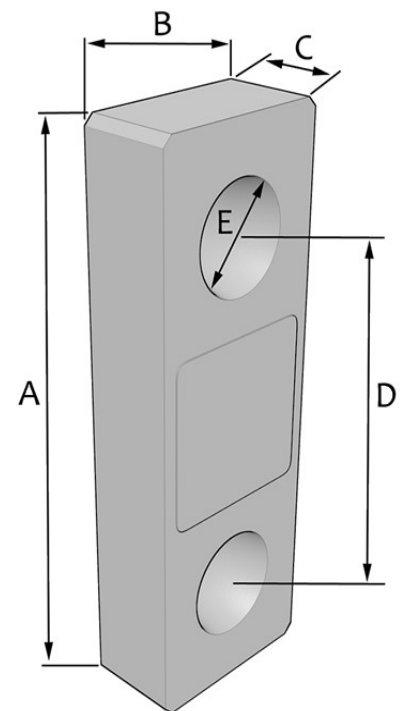

Display Units	tonne
Battery life	250 hours minimum
Wireless Range (LM-W)	100 metre (direct sight)
Cable Length (LM-C)	10 metre
Maximum Error	0.25 % applied load
Safety Factor	5 x rated capacity
Operating Temperature	0 to 50 °C
Environmental Sealing	IP65

Specifications subject to change. Full product details available on request.

0117 9381 600

**SLG** SAFETY LIFTING GEAR.COM

LML\_TA\_1