

- ◆ Forged super alloy steel Quenched and Tempered
- ◆ Suitable for G100 chain.
- ◆ 25% stronger than G80.
- ◆ Individually proof test at 2.5 times Working Load Limit.
- ◆ Fatigue tested at 1.5 times Working Load Limit for 20000 cycles
- ◆ 100% magnaflux crack detection
- ◆ Surface finish: Powder plastified
- ◆ Colour code: Blue
- ◆ Positive lock latch is selflocking when hook is loaded.

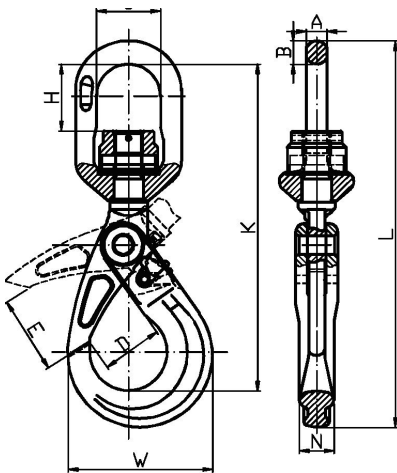

ITEM CODE	WEIGHT (KG)	WLL (T)	B.L (T)	A±1.5	B±1.5	C±2	D±2	E±2.5	N±1	H±3	K±3	L±5	W±3
BB-G100-6-SSLH	0.67	1.4	5.6	11.5	13	37	27	30	15	32	163	196.5	70
BB-G100-8-SSLH	1.21	2.5	10	13	15	41	35.5	40	20	39	202	243	90
BB-G100-10-SSLH	2.2	4	16	15.5	17.5	48	45	48	26	48	244	289	108
BB-G100-13-SSLH	4.4	6.7	26.8	17	19	55	52.5	63	32.5	57	292	351	138
BB-G100-16-SSLH	7.48	10	40	21.5	26	62	62	75	38	62	346	422	170
BB-G100-20-SSLH	13.75	16	64	26.5	28.5	76	76	80	50	72	396	487	191
BB-G100-22-SSLH	18.81	19	76	33	33	97	79	95	52	97	465	563	208