

## TTT Horizontal girder clamps

### Split toe plate

**Working load limit (WLL) 750 - 4500 kg**

The TTT horizontal girder clamps have been designed to be used in pairs and can be used on girders up to a surface hardness of HRC 30/Brinell 300.

The unique design of the split toe allows long sections of girders to be fitted without the use of a spreader beam.

### Workmanship and parts

These plate clamps are service-friendly, making it easy to exchange parts, which are readily available. Clamp repairs must be done by a trained person.

**Product group: I2**



## INFO

These clamps are to be used in pairs with a 2-legged chain sling.



### Technical data TTT

Model	Art.-No.	*WLL kg	Jaw (Z) Capacity mm	*Weight kg
TTT0.75	N54509121	750	0 - 20	3
TTT1.5	N54509122	1500	0 - 35	6
TTT3.0	N54509123	3000	0 - 40	10
TTT4.5	N54509124	4500	0 - 45	16

\*Per clamp

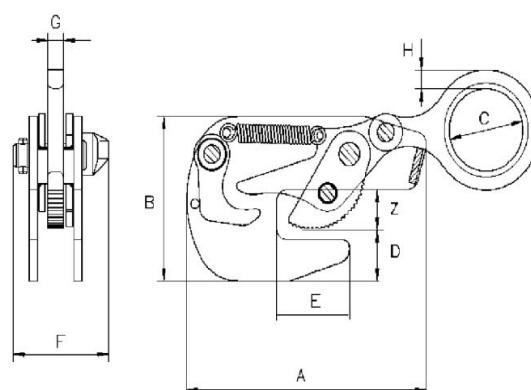

### Dimensions TTT

Model	TTT0.75	TTT1.5	TTT3.0	TTT4.5
A, mm	225	225	225	225
B, mm	142	180	195	222
C, mm	70	80	84	105
D, mm	45	56	60	65
E, mm	70	70	75	90
F, mm	106	120	125	147
G, mm	16	19	19	22
H, mm	16	20	25	30